

Flexible Roche coil with threaded head

OVERVIEW

Flexible current sensors can be directly combined with portable devices such as power analyzers to form very flexible systems. Suitable for energy consumption monitoring, high-frequency current monitoring, DC ripple measurement, etc. Different sizes can be customized according to requirements.



ENVIRONMENTAL

Roche coil center	< 0.5%
Coil part	< 1%

SPECIFICATION

Excellent linearity
High dynamic range, 1A to 500KA
Strong overload capability
Low interference from adjacent conductors
There is no risk of open circuit and high voltage
Zero power consumption
Low position error
Soft and lightweight, easy to install
Good linearity

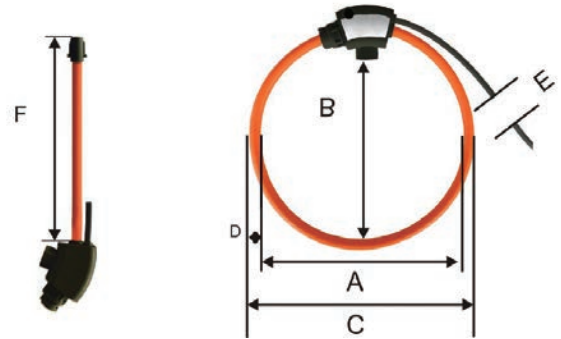
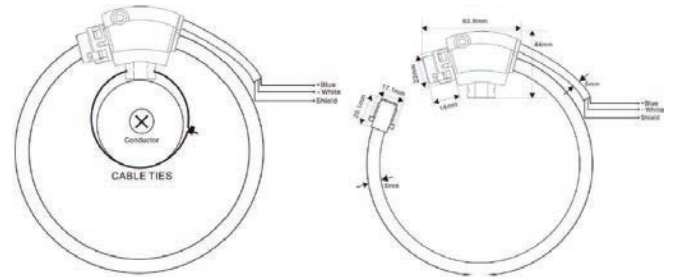

ELECTRONICAL

MODEL	NRCT-100	NRCT-150	NRCT-200
Perimeter	395mm	525mm	665mm
Internal diameter	100mm	150mm	200mm
Reference current	≤500kA		
Coil resistance	50-250Ω		
Maximum current	500kA		
Signal line length	Default 2m, customizable		
Calibration	100±0.5% $mV/kA@50Hz$	85±0.5% $mV/kA@50Hz$	50±0.5% $mV/kA@50Hz$
Not calibrated	120±5% $mV/kA@50Hz$ 106±5% $mV/kA@50Hz$		
Internal resistance	Uncalibrated 200ppm/C	Calibrate 50ppm/C	

MECHANICAL

size (mm)	NRCT-100-2M	NRCT-150-2M	NRCT-200-2M
A. Window size	135	165	210
B. Window size	100	150	200
C. Outer diameter of coil	151	181	226
D. Coil cross-section	8		
E. Signal line lengthB. Window size	2M		
F. Coil length	395	525	665

INSTALLATION METHOD:

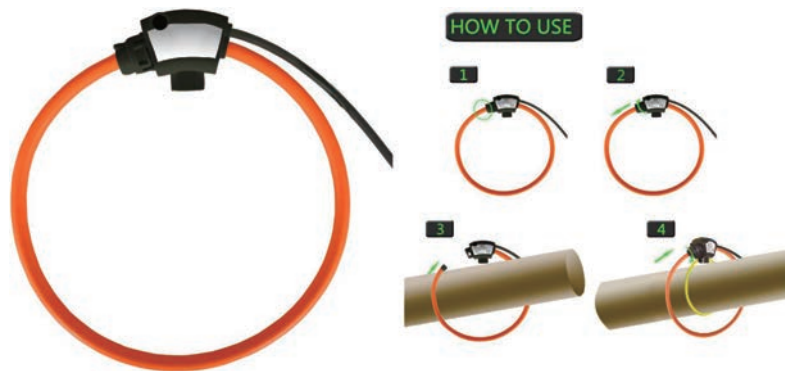

ATTENTION!

I Do not forcefully pull

II Do not bend forcefully

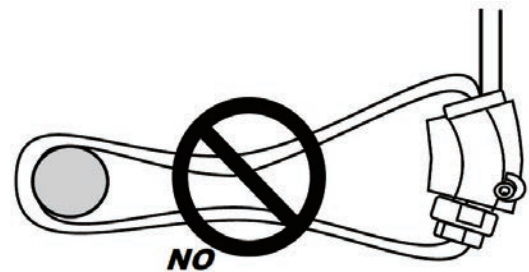
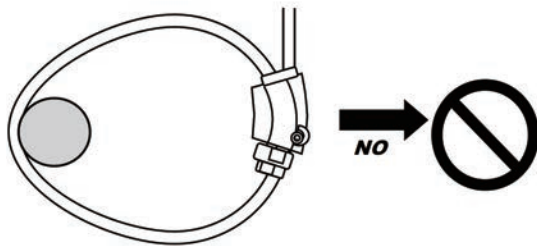

III Do not package in a bent state

